

## **SHH-AG Series Pre-fold Crash Lock Bottom Automatic Folder Gluer**

SHH-800AG, SHH-600AG

This machine is specially used for paperboard shaping and adhesive processing after cutting horizontally. Its universality is strong and suitable scope is wide, which can fold and paste various straight seaming box and bottom edging box.

It is widely used in food, medicine, cosmetics, stationery and other ordinary cartons, process and glue for all kinds of bottom-locked cartons. Pre-fold section is applied to auto packaging, fold 1 and fold 3 of all cartons can reach 180° and 135° ,perfectly combing the requirements of auto packaging together.

### Table of Contents

- Characteristics
- Technical Parameter
- Related

Model	SHH-800AG, SHH-600AG
Paper Material	200-800 gsm cardboard and E, F corrugated paper.
Max. Liner speed	220m/min
Feeding Way	Automatically and continuously feeding.
Way of Folding in reverse	Fold 1 and fold 3 are 180 degree and 135 degree. Fold 2 and fold 4 are 180 degree.
Glue Material	Water-base cold glue.
Electric Power	3P 380V 50Hz
Main Power	7kW
Weight	2.4T, 2.2T
Over Dimension	11×1.3×1.4m, 11×1.1×1.4m

## Common Box Type and Size

### Technical Parameter

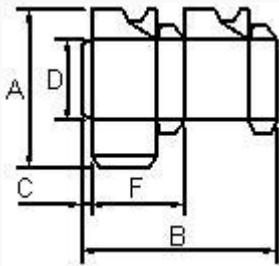

### Lock Bottom Carton Type and Folded Box Size

Model	SHH-800AG		SHH-600AG	
Paper Material	Cardboard	E/F Corrugated Paper	Cardboard	E/F Corrugated Paper
A	150-600mm	150-550mm	150-600mm	150-550mm
B	200-750mm	200-750mm	200-550mm	200-550mm
C	Min.: 10mm	Min.: 10mm	Min.: 10mm	Min.: 10mm
D	Min.: 70mm	Min.: 120mm	Min.: 70mm	Min.: 120mm
F	Min.: 80mm	Min.: 100mm	Min.: 80mm	Min.: 100mm

Model	SHH-800AG		SHH-600AG	
Paper Material	Cardboard	E/F Corrugated Paper	Cardboard	E/F Corrugated Paper
A	120-700mm	150-550mm	120-700mm	120-600mm
B	120-780mm	200-750mm	120-580mm	180-600mm
C	Min.: 10mm	Min.: 10mm	Min.: 10mm	Min.: 10mm
D	Min.: 50mm	Min.: 100mm	Min.: 50mm	Min.: 100mm
F	Min.: 50mm	Min.: 75mm	Min.: 50mm	Min.: 75mm